

REVISIONS			
REV.	DESCRIPTION	DATE	APPROVED
1	INITIAL RELEASE OF DRAWING	5/28/2014	BS

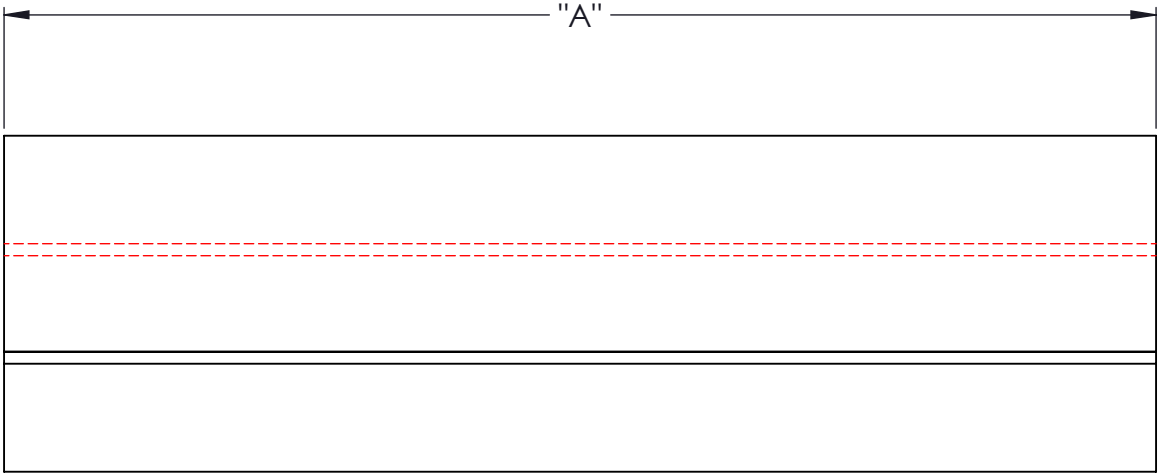
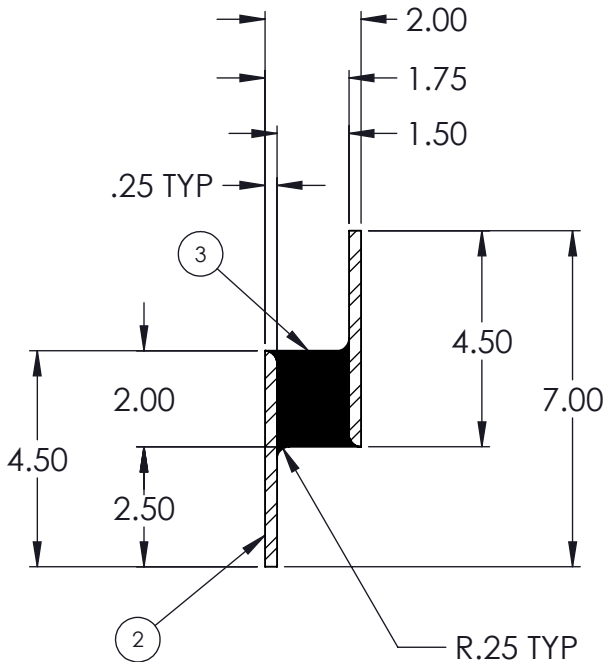

AR	NATURAL RUBBER	K14-3		3
2	MK140	MK140		2
	K14	K14		1
QTY.	DESCRIPTION	PART NUMBER	MATERIAL OR NOTES	ITEM

NOTES:

MATERIAL: A36 STEEL.

MATERIAL: 50 DUROMETER NATURAL RUBBER.

3 DIMENSION "A" IS TO BE MANUFACTURED IN LENGTHS OF 6" AND 24".

PROPRIETARY AND CONFIDENTIAL THE INFORMATION CONTAINED IN THIS DRAWING IS THE SOLE PROPERTY OF KARMAN RUBBER. ANY REPRODUCTION IN PART OR AS A WHOLE WITHOUT THE WRITTEN PERMISSION OF KARMAN RUBBER IS PROHIBITED.	SIGNATURE		DATE	UNLESS OTHERWISE SPECIFIED: DIMENSIONS ARE IN INCHES TOLERANCES: .X = ± 0.1 .XX = ± 0.01 .XXX = ± 0.005 ANGLES = ±1° INTERPRET GEOMETRIC TOLERANCING PER: ASME Y14.5M-1994
	DRAWN	B. SENECA	05/28/2014	
	CHECK	S. BROWN	05/28/2014	
	ENGR	B. SENECA	05/28/2014	
	QA			
	STRESS			
	APPR			



**KARMAN RUBBER
VIBRO-INSULATORS®**

FOR CONTROLLING NOISE, SHOCK & VIBRATION

B	SIZE	CAGE CODE
	DO NOT SCALE DRAWING	

TITLE:

**K14 CONTINUOUS STRIP
VIBRO-INSULATOR**

WWW.KARMAN.COM

DWG. NO.	REV	
K14	1	
SCALE: 1:4	WEIGHT: N/A	SHEET 1 OF 1